

CODE	Dn	S min	Di	Peso - Weight (Kg/m)
16V6002	20	3,4	13,20	0,17
16V6003	25	4,2	16,60	0,26
16V6004	32	5,4	21,20	0,43
16V6005	40	6,7	26,60	0,66
16V6006	50	8,4	33,20	1,03
16V6007	63	10,5	42,00	1,62
16V6008	75	12,5	50,00	2,29
16V6009	90	15,0	60,00	3,30
16V6010	110	18,4	73,20	4,92
16V6011	125	20,8	83,40	6,30

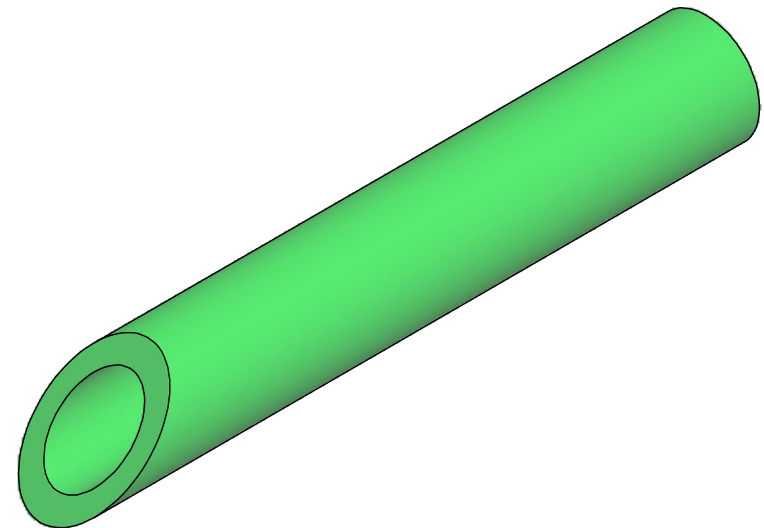

BARRE DA 4m
BAR LENGTH 4m



PolySYSTEM

ITEM: **V60**

C:\Vault_Temp\Disegni\Schede Tecniche\Polysystem metric\Monolayer pipes\PS10044.dwg

DESC: TUBO NIRON-POLYSYSTEM PP-RCT
VERDE - SINGOLA PARETE
NIRON-POLYSYSTEM FULL GREEN PP-RCT
PIPE - MONOLAYER PIPE
SDR6 - S 2,5



DRAWING No:
PS10044

SHEET OF	REV.
1 1	-2

www.nupiindustriaitaliane.com - info@nupinet.com

All dimensions have to be considered in millimeters with 5% tolerance if not otherwise mentioned excluding values as per standard EN ISO 15874